

Privilege

EUPHORIE 5



Specification

Pure power meets puristic design



Specification

LOA	15.24 m	50'
Hull length	15.24 m	50'
LWL	15.13 m	49'6"
Beam	7.98 m	25'3"
Draft	1.10 m	3'8" TBC
Displacement light ship	20 t	44,092 lbs TBC
Displacement full load	25 t	59,525 lbs TBC
Fuel tank	2 × 545 l	2 × 144 gal
Fresh water	2 × 300 l	2 × 79 gal
Engine Diesel	2 × 165 kW	2 × 220 HP
CE Certificate	B	
Design	Cabinet Marc Lombard	
Interior	Darnet Design	

All measurements are approximate. Specifications and material can change without notice. Errors excepted. Valid 2019.08.01



Specification

General

- › Euphorie 5 with master suit layout and 2 guest cabins
- › Declaration of Conformity according to European Directive 2013/53/UE
- › 5 years structural guarantee on hull, deck and bulkheads
- › Owner's manual
- › Administration fees

Hull

General

- › Hulls and bridge deck infused with closed cells PVC foam core
- › Isophthalic gelcoat – colour: Signal White, RAL 9607
- › 1st layer in vinyl ester resin to prevent osmosis
- › Polyester resin for infusion

Structure

- › Monolithic areas and plywood/ aluminium reinforcements under infusion

Bulkheads

- › Structural bulkheads infused with closed cells PVC foam core
- › Bulkheads directly laminated to hull and bridge deck

Additional parts

- › Crash boxes at false bow and transom

Keel

- › Fixed skegs under the hulls

Deck

General

- › Deck infused with closed cells PVC foam core
- › Isophthalic gelcoat – colour: Signal White, RAL 9607
- › 1st layer in vinyl ester resin

- › Polyester resin for infusion

- › Aft cockpit with L-shape bench on starboard and straight benches on portside and on aft beam

Structure

- › Monolithic areas and plywood/ aluminium reinforcements under infusion
- › Deck laminated to hull and bulkheads laminated to deck

Deckhouse

- › Large coachroof with 3 ventilation hatches

Flybridge

- › Flybridge with large U-bench
- › Navstation on starboard side

Additional parts

- › 2 lockers on foredeck, accessible through deck hatches with ventilation and ladder, lockable
- › 2 lockers on central pod accessible through deck hatches with ventilation and ladder, lockable
- › 1 locker for anchoring storage
- › 6 cockpit lockers incl. one for life raft
- › 2 cockpit lockers in the aft beam

Exterior equipment

Glazing

- › Stainless steel patio door to saloon with 3 leaves, 2 sliding
- › Large mineral glass windows on hull and deckhouse
- › Flush hatches on deck and deckhouse

Specification

Mooring – Anchoring

- › 8 stainless steel mooring cleats, 500 mm 4x, 360mm 4x
- › 8 stainless steel anti-chafing protections
- › 2 stainless steel mooring cleats, 360 mm, at transom
- › 4 mooring lines
- › 8 fenders, 91 cm x 36 cm
- › 1 electric anchor windlass 2000W with deck switch gypsy Ø 12mm
- › Bow anchor roller with cleat
- › Mooring bridle
- › Stainless steel plate to prevent anchor chain chafing
- › Main mooring line with galvanized Delta-Anchor 40 kg, swivel 75 m galvanized chain Ø 12 mm, 25 m rope

Deck fitting

Deck

- › 2 stainless steel pulpits with teak seats and LED navigation lights
- › 4 stainless steel pushpits, 2 outside, 2 inside transoms
- › Complete rigid railing, side and front, 750 mm height, with 2 guard lines in stainless steel
- › 2 white PVC coated nets 1000 g/m²
- › 2 handrails on deckhouse
- › Stairs from forward deck to deckhouse with removable handrail
- › Stairs from cockpit to side deck

Aft cockpit

- › Fixed teak cockpit table
- › Helicoidal stainless steel stairs from cockpit to flybridge

Navstation

- › Navstation with two pilot seats on starboard side
- › Windscreen in plexiglass with stainless steel frame
- › GRP hard-top for navstation

Flybridge

- › Fixed teak coffee table

Transoms

- › Fixed stainless steel swimming ladder on port transom

Upholstery

- › Upholstery for cockpit - Silvertex 122-0001 Macadamia

Interior

General

- › Furniture - Alpi Walnut style, satin varnish
- › Floorboard - laminated wood Resopal Valley Oak
- › All worktops in synthetic resin - Solid range S028 Ivory White
- › Upholstery - Silvertex 122-0001 Macadamia
- › Lining ceiling and wall: Spradling Hitch Iceberg 8969, except center saloon ceiling in Spradling Silvertex Ice 4004
- › Lining bed frames, headboards and bed sides: Spradling Vogue Stone 001 or Eucalyptus 004 according to wood colour
- › White solid surfaces: Duopal Cristal White U11026 SM
- › Dark solid surfaces: Egger Graphite Grey U961 STPT
- › Curtains type OCEANAIR in all the boat
- › Spring frames and mattresses for all the beds

Front cabins - according to layout

Master suit

Port wd

- › 1 dressing

Outer side

- › 1 large and tall cabinet with 3 doors incl. 1/3 shelves 2/3 wardrobe
- › 1 large desk with storage

Inner side

- › 1 large and tall cabinet with 3 doors
- › 1 large and tall cabinet with integrated mirror & numerous storage and drawers

Central pod

- › 1 lengthwise double bed 160 cm x 200 cm, 2 bed sides, 2 low cabinets with drawers

Specification

Stbd fwd

- › 1 separate shower with thermostatic tap and silk-screened door

Stbd outer side

- › 1 large and tall cabinet incl. 1/2 wardrobe 1/2 shelves, chest of drawers with 2 drawers at the top and shoes storage at the bottom
- › 1 tall wardrobe with drawers at the bottom, 1 separate electric toilet

Stbd inner side

- › 1 head cabinet with 2 doors and 1 counter top wash basin
- › 1 large and tall cabinet with integrated mirror & numerous storage and drawers

Master cabin and port guest cabin:

Port fwd

- › 1 separate shower with thermostatic tap and silk-screened door

Port outer side

- › 1 large and tall cabinet incl. 1/2 wardrobe 1/2 shelves, chest of drawers with 2 drawers at the top and shoes storage at the bottom
- › 1 separate head with electric toilet, wash basin, mixing tap, mirror and accessories

Port inner side

- › 1 lengthwise single bed 105 cm x 200 cm
- › 1 large and tall cabinet with integrated mirror & numerous storage and drawers

Central pod

- › 1 lengthwise double bed 160 cm x 200 cm, 2 bedsides, 1 low cabinets with drawers

Stbd fwd

- › 1 separate shower with thermostatic tap and silk-screened door

Stbd outer side

- › 1 large and tall cabinet incl. 1/2 wardrobe 1/2 shelves, chest of drawers with 2 drawers at the top and shoes storage at the bottom
- › 1 tall wardrobe with drawers at the bottom, 1 separate electric toilet

Stbd inner side

- › 1 head cabinet with 2 doors and 1 counter top wash basin
- › 1 large and tall cabinet with integrated mirror & numerous storage and drawers

2 double cabins:

Port fwd

- › 1 separate shower with thermostatic tap and silk-screened door

Port outer side

- › 1 large and tall cabinet incl. 1/2 wardrobe 1/2 shelves, chest of drawers with 2 drawers at the top and shoes storage at the bottom
- › 1 separate head with electric toilet, wash basin, mixing tap, mirror and accessories

Port inner side

- › 1 transverse double bed 160 cm x 200 cm, 2 bedsides, 1 low cabinet on footboard
- › 1 large and tall cabinet with integrated mirror & numerous storage and drawers

Stbd fwd

- › 1 separate shower with thermostatic tap and silk-screened door

Stbd outer side

- › 1 large and tall cabinet incl. 1/2 wardrobe 1/2 shelves, chest of drawers with 2 drawers at the top and shoes storage at the bottom
- › 1 separate head with electric toilet, washbasin, mixing tap, mirror and accessories

Stbd inner side

- › 1 transverse double bed 160 cm x 200 cm, 2 bedsides, 1 low cabinet on footboard
- › 1 large and tall cabinet with integrated mirror & numerous storage and drawers

Port corridor

- › 1 tower in front of the stairs with 1 stainless steel freezer 130 l at the bottom & cabinet at the top
- › 5 stairs with courtesy lights & escape hatch

Specification

Starboard corridor:

Outer side

- › 1 technical cabinet for washer/ dryer in option

Inner side

- › 5 stairs with courtesy lights & escape hatch

Aft port side - guest cabin:

Aft

- › 1 lengthwise double bed 160 cm x 200 cm
- › 1 full length wardrobe on inner side

Outer Side

- › 1 separate head with electric toilet, wash basin, mixing tap, mirror and accessories

Inner Side

- › 1 separate shower with thermostatic tap and silk-screened door

Aft starboard side - guest cabin:

Aft

- › 1 lengthwise double bed 160 cm x 200 cm
- › 1 full length wardrobe on inner side

Outer Side

- › 1 separate head with electric toilet, wash basin, mixing tap, mirror and accessories

Inner Side

- › 1 separate shower with thermostatic tap and silk-screened door

Galley & salon

Dinning area

- › 1 L-shape bench
- › 1 fixed rectangular dining table
- › 1 cupboard behind the fixed leave of the patio door

Galley area

- › 1 electric cooker
- › 1 electric oven
- › 1 built-in dish washer, 9 dishes in option
- › 1 stainless steel fridge 130 l without freezer
- › 1 large sink with mixing tap
- › 1 integrated waste bin
- › Worktop in synthetic resin
- › Numerous storage and drawers

Navigation area

- › Chart table with footstool
- › Wall panel for receiving electronics, monitoring and entertainment
- › Adjustable LED light

Specification

System

Air

Air conditioning

- › A/C system predisposition for future chiller, power and sea water connection, handlers power and chilled water/ glycol circuit, insulation hoses

Electrics & electronics

General

- › 12Vdc network
- › 230Vac, 50Hz network
- › Supervision system management with controller for data capture and 2 touch screen 10" to check: AC/DC networks, gauges & pumps, lighting, service switches, alarms history

Wiring & control boxes

- › Set of control boxes divided into the boat incl. brakers and control relays
- › Shore power outlet 230Vac, 50Hz, 32A with shore cable

Batteries & chargers

- › 4 service gel batteries 200Ah, 12Vdc
- › 2 gel batteries 55Ah, 12Vdc for engines
- › 1 gel battery 55Ah, 12Vdc for generator
- › Inverter, charger 3kW, 120A, 3000W, 12V

Generator

- › Generator power to be defined according to energy needs and/ or navigation program

Lighting

- › LED downlights daylight divided into the boat incl. cockpit, white and red in saloon and aft cockpit
- › LED reading lights daylight divided into the cabins
- › 1 flexible reading light at chart table
- › 2 LED lights on each transom

Electric devices

- › 230Vac, 50Hz circuit with 1 outlet in each cabin, 2 in the master cabin, 2 in the galley, 1 in the saloon and 2 at chart table = 9
- › Twin USB charging at chart table

Navigation instruments

- › 2 Raymarine i70s at helm station with DST transducers for Depth/Speed/Temperature/Wind
- › GPS Receiver RS150
- › VHF antenna, 2 Ray 90 at navstation & chart table
- › Magnetic compass, northern hemisphere
- › Mechanical wind vane

Entertainment

- › Hertzian masthead antenna
- › AM/FM Antenna
- › Prewiring TV and Hifi in saloon and cabins

Propulsion

General

- › 2 sound-proof and heat insulated engine compartments, ventilation fans, LED lights with access from cockpit by hatches
- › 2 Yanmar engines, inboard shaft 250 hp with electrical throttles incl. maintenance kit
- › 2 4-blade Gori folding propellers

Steering

- › Hydraulic steering system
- › Stainless steel steering wheel with leather cover
- › 2 stainless steel emergency tillers

Water & gas system

- › 2 stainless steel fresh water tanks 2 x 300 l
- › 40 l hot water boiler, 230V
- › Pressurized water system with stainless steel expansion tank
- › 2 manual bilge pumps with 3-way-valve
- › 4 electric bilge pumps with visual and audible alarms
- › Electric shower pumps
- › 2 polypropylene blackwater tanks 2 x 106 l
- › Mixing taps for heads and showers
- › Electric toilets with fresh water flush
- › Warm/ cold water deck shower on port transom

Fuel

- › 2 aluminium fuel tanks 545 l each

Deck & cabin concept

Maindeck



Flybridge



Flybridge
T-Top
option

Lower deck

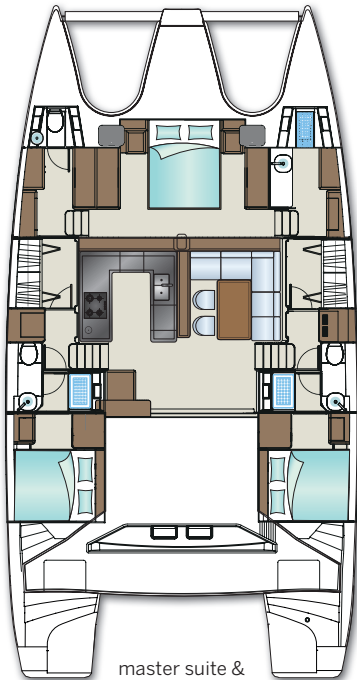

master suite &
2 guest cabins

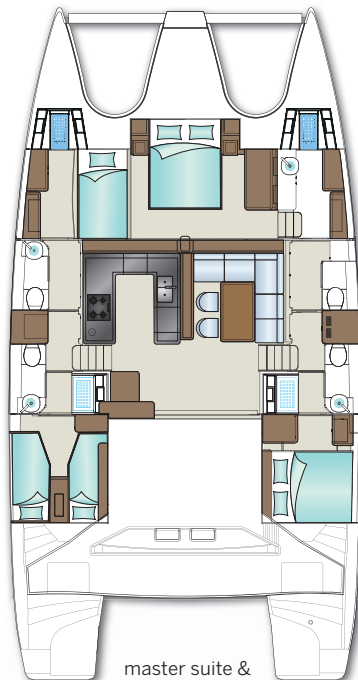

master suite &
3 guest cabins
option

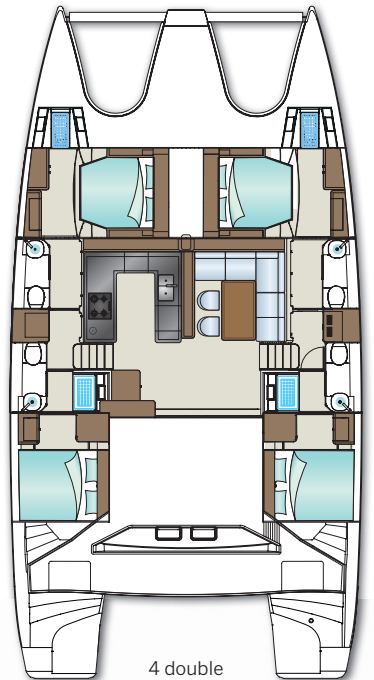

4 double
cabins
option