

AZIMUT 35

2022

LOVE T

€ 11,400,000 EX VAT



Benetti

ATLANTIS
COLLECTION

MAGELLANO
COLLECTION

FLYBRIDGE
COLLECTION

COLLECTION

Grande
COLLECTION

The Yacht



The Yacht



The Yacht



The Yacht



The Yacht



The Yacht



The Yacht



Balcony



Balcony



Bow Sunset



Bow



Table Flybridge Dining



Flybridge Bar



Flybridge



Flybridge



Cockpit



Cockpit



Cockpit



Pilot House



Bech Club & Toys Exterior



Club Sunset Beach



Beach Area&Toys



Beach Area&Toys



Beach Area&Toys



Beach Club



Saloon



Saloon



Saloon



Master Cabin



Guest Cabin



Guest Cabin



Guest Cabin



Twin Cabin



Layout

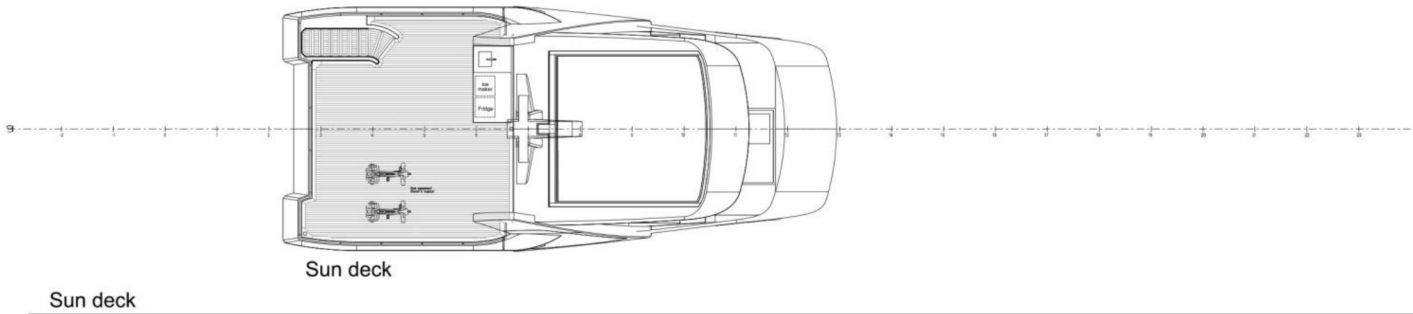

Layout



Layout

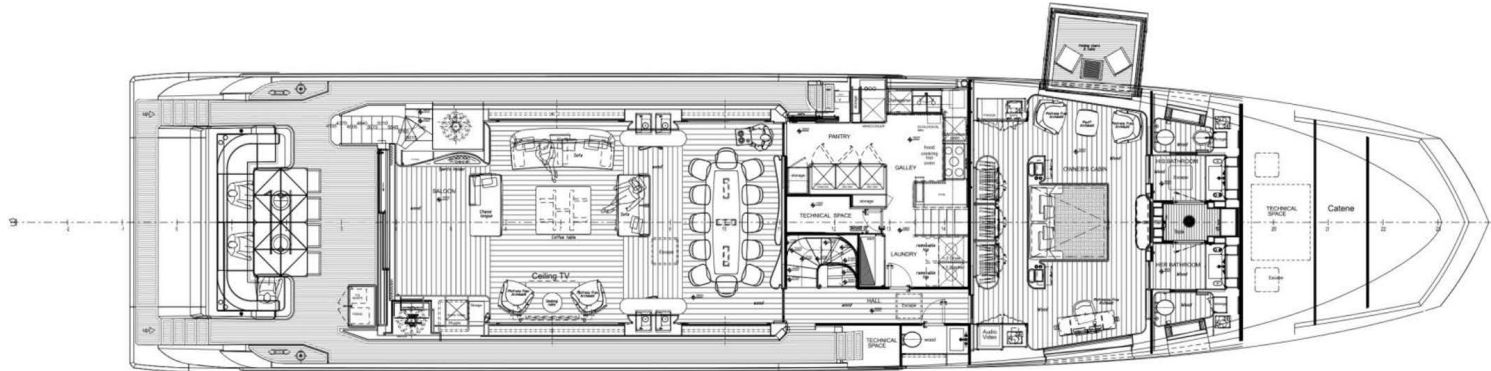

Main deck

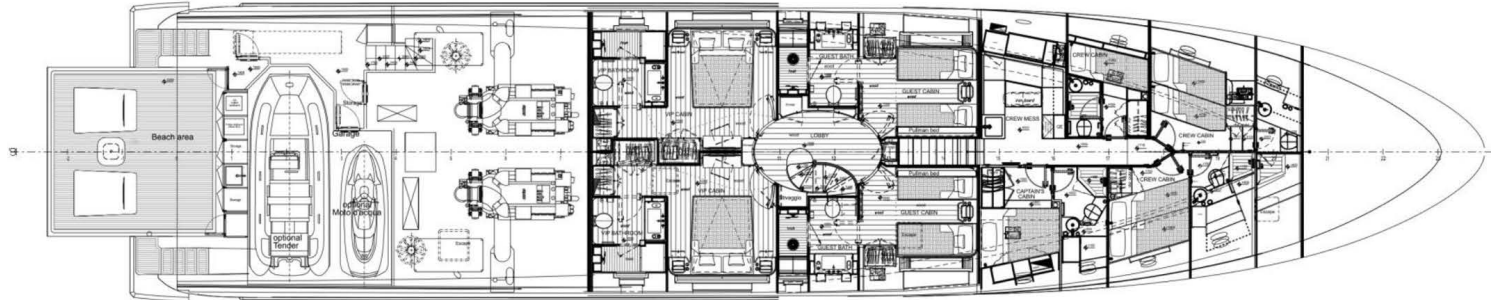

Lower deck

Specs

SPECIFICATIONS

- Length Overall (including pulpit): 35 m
- Beam max: 7.50 m
- Draft: 1.91 m
- Displacement (at full load): 154 t

PERFORMANCE

- Engines: 2 x 2.400 Mph (1790 KW) MTU 16V 2000 M93
- Engine hours: 503 hrs (February 2023)
- Generators: 2 x KOHLER 70 KW / 50 Hz
- Generator hours: 2180.1 hrs / 2166.5 hrs (February 2023)
- Max speed: 26 kn
- Cruising speed: 21 kn

ACCOMMODATION

- Cabins: 5 + 4 crew
- Berths: 10 + 6 crew
- Head Compartments: 6 + 4 crew

TANK CAPACITY

- Fuel capacity: 18000 l
- Fresh water: 3000 l
- Sewage and grey water: 2500 l

Specs

GENERAL

- Balcony at portside (in master cabin)
- Electric stern thruster
- Layout std
- Additional soundproof insulation between saloon and engine room
- Additional soundproof insulation in master cabin
- Upgrade A/C "Gulf Version"
- Double Racor filters for generators
- Safety equipment including crew and extinguishers
- Water softener and water purifier

Garage

- Tender filling station from main fuel tanks

Specs

EXTERIOR

- 1 Additional sundeck with teak flooring in lieu of standard aft hard top
- 16 mm stud less chain – 150 m MV16 windless 140 kg

Bow area

- Cover for bow sitting area

Flybridge

- Teak flooring on all flybridge
- Flybridge bar cabinet
- Refrigerator on flybridge
- Icemaker
- 2 coffee tables
- Barbeque Texan grill

Aft cockpit

- Electric main door in saloon
- RIGID Telescopic handrails on both sides of the gangway
- Cockpit enclosure
- Cockpit manual shade net
- Cockpit bar cabinet with refrigerator and icemaker

Beach area

- 2 chaise longue
- Coffee table

Specs

INTERIORS

- Central vacuum system
- Latex – memory foam mattress
- Safe in VIP port / VIP stb and crew

Galley – Pantry

- Wine cooler in galley
- Professional dishwasher
- Additional washer and dryer
- Pot holder on induction hob
- Galley trash bin

Master cabin

- Fridge in master cabin
- 2 x holding armchairs
- Folding coffee table for the balcony
- Massage bed storage in owner's cabin
- Vanity with drawer
- Glass cover shelf in owner's portside cabinet
- Rails for total blackout curtains
- Vanity chair
- Safe with internal light in lieu

Saloon

- Dining chairs in starboard
- 4-seat sofa without armrest
- 2-seat sofa without armrest on portside
- 2-seat sofa without armrest
- Small coffee table
- Bottle holder on top of Port entry cabinet (10 bottles)

Lobby

- Refrigerator in lower deck lobby

Guest cabins

- Additional folding bed in each guest cabin
- Guest cabin filler cushions
- Folding iron shelf in crew mess

Specs

ELECTRICAL SYSTEM

- 6 x Underwater lights under swim platform
- Automatic parallel between generators
- Dimmer for external lights
- One Glendinning cabelmasters
- Spot lights on aft flybridge
- Additional ceiling lights in Galley
- Electric curtains in main deck (saloon + master)
- Reading light in Vanity desk in master cabin

NAVIGATION & CONTROLS

- Upgraded navigation package FURUNO
- AIS
- Remote control for main engines and bow thruster in cockpit and on flybridge

ENTERTAINMENT SYSTEM

- Upgraded A/V package – including beach speakers
- Fixed video camera in aft cockpit ceiling
- Zooming and pivoting video camera in engine room – connected to navigation system
- Camera in saloon

Disclaimer

All speeds, measurements, capacities, consumptions, etc. may be approximate or estimated. Specifications provided for information only. Data was obtained from sources believed to be reliable and is not guaranteed by owner or brokers. Buyer assumes the responsibility to ascertain the correctness of all data contained herein and otherwise provided and must instruct his agent and surveyors to confirm all details for accuracy prior to purchase. Subject to prior sale, price and inventory change, or withdrawal from market without notice.



Benetti

ATLANTIS
COLLECTION

MAGELLANO
COLLECTION

FLYBRIDGE
COLLECTION

S
COLLECTION

Grande
COLLECTION

For more information please contact: Niso Gadot
+972-50-7644438 | niso@azimutyachts.co.il | www.azimutyachts.co.il
